

36"

3"

32"

1"

24"

20"

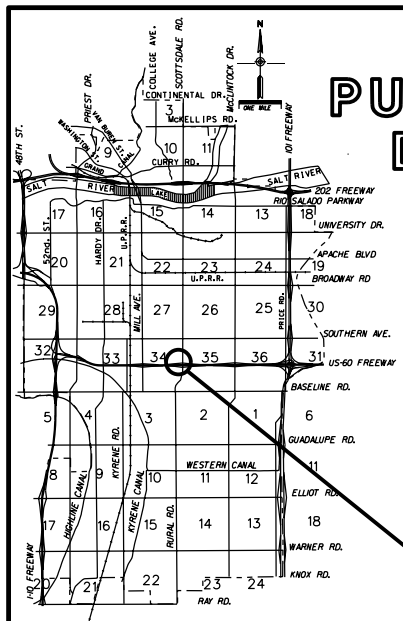

**CITY OF TEMPE
PUBLIC WORKS DEPARTMENT
DIVISION OF ENGINEERING**

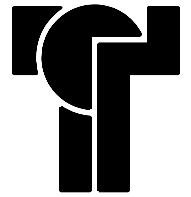

**JOYCE PARK IMPROVEMENTS
NEW RAMADA**
711 E. HERMOSA DRIVE
PROJECT NO. 6305031

SHEET INDEX

DESCRIPTION	SHEET NO.
COVER SHEET	1
JOYCE PARK IMPROVEMENTS NEW RAMADA AND CONSTRUCTION NOTES	2
DETAILS	3
RAMADA	4,5
ELECTRICAL	6

UTILITY INFORMATION

N/A	DATE
AT & T	DATE
QWEST COMMUNICATIONS	DATE
N/A	DATE
ARIZONA PUBLIC SERVICE CO.	DATE
N/A	DATE
AIR PRODUCTS	DATE
N/A	DATE
SALT RIVER PROJECT-WATER	DATE
N/A	DATE
SALT RIVER PROJECT-POWER	DATE
N/A	DATE
EL PASO NATURAL GAS CO.	DATE
N/A	DATE
SOUTHWEST GAS CORP.	DATE
N/A	DATE
CABLE - TV	DATE

MAYOR
HUGH HALLMAN

CITY COUNCIL
P. BEN ARREDONDO
SHANA ELLIS
MARK MITCHELL
JOEL NAVARRO
ONNIE SHEKERJIAN
CORBY D. WOODS

CITY MANAGER
CHARLES W. MEYER

CITY ENGINEER
ANDREW H.Y. GOH, P.E.

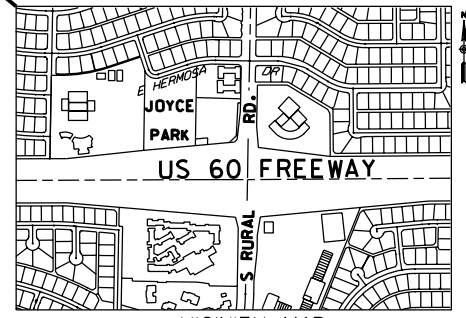

VICINITY MAP
711 E. HERMOSA DRIVE

APPROVED

DEPUTY PUBLIC WORKS MANAGER/ DATE
CITY ENGINEER

N/A DATE
MARICOPA COUNTY ENVIRONMENTAL SERVICES DEPARTMENT



REFERENCE TO SECTION LOCATION	AS-BUILT INFORMATION IS INCLUDED IN THESE AREAS OF THIS SET OF DRAWINGS	ITEMS REQUIRED FOR THIS SET OF DRAWINGS
NE34N4	<input type="checkbox"/> SEWER <input type="checkbox"/> WATER <input type="checkbox"/> WATER-RECLAIMED <input type="checkbox"/> STORM DRAIN/STORMWELL <input type="checkbox"/> PAVING <input type="checkbox"/> OFFSITE (I.C.S.W.D.B.) <input type="checkbox"/> GRADING/DRAINAGE	<input type="checkbox"/> FIRE LINE <input type="checkbox"/> CITY MISC. <input type="checkbox"/> ONE PATH <input type="checkbox"/> STREETS LIGHTS <input type="checkbox"/> BUILDINGS <input type="checkbox"/> OTHER
AS-BUILT PLANS CHECKED FOR FIELD CHANGES	DATE	PARCEL #
INSPECTION		PROJECT #
SHT. 1 OF 2		

PROJECT # 6305031 DS# EN# TITLE: JOYCE PARK IMPROVEMENTS NEW RAMADA

NOTE:
THIS EXAMPLE OF COVER SHEET FOR THE CITY OF TEMPE "CIP" DESIGN PROJECTS, TO FOLLOW COT'S DRAFTING GUIDES, OVERALL SIZE OF DRAFTING AREA TO BE 20" X 32" ALL TEXT SIZES SHALL BE LEGIBLE AFTER 50% REDUCTION TO 11" X 17". FINAL CONSTRUCTION PLANS TO BE PLOTTED ON 24" X 36" MINIMUM THREE (3) MIL MYLAR, IMAGE MUST BE ON FRONT SIDE OF MYLAR. THIS SHEET WAS UPDATED ON MAY 2009.